



Hepworth Court, 30 Gatliff Road
London SW1W

GARTON JONES.COM

Hepworth Court, 30 Gatliff Road
London, SW1W

GARTON JONES.COM

8 Gatliff Road
Grosvenor
Waterside
Chelsea
London
SW1W 8DP

Sales +44 (0) 20 7730 5007
gws@gartonjones.com
www.gartonjones.com

£850 Per Week

A TWO DOUBLE BEDROOM apartment of approx. 788sq.ft (73sq.m) to rent in Hepworth Court, Grosvenor Waterside, a popular residential development built around historic docks and close to the banks of the River Thames by Chelsea Bridge. This part furnished apartment has a good sized open plan reception room with an integrated appliances. There is a modern bathroom, wood flooring, comfort cooling, a large private terrace with a nice view overlooking the dock. There is storage including fitted wardrobes to the master bedroom and a utility cupboard housing a washer dryer. 24 HOUR CONCIERGE, GYM & SPA. On-site Sainsbury's Local, coffee shop and private kids club. SLOANE SQUARE & VICTORIA station with Gatwick Express are within walking distance.



Available via Garton Jones' on-site office at Grosvenor Waterside (underneath Bramah House).

*Please note furniture may differ to that shown in the current photos or may not be included.
Council Tax: Westminster City Council (band G).
EPC Rating ; B

12 month minimum term. 5 week deposit required.

EPC certificate available on request.



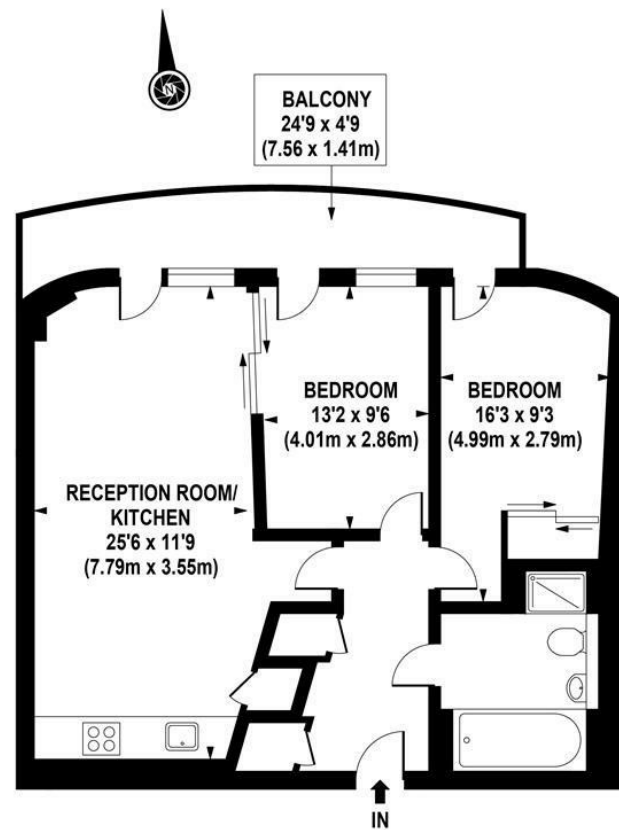

FIRST FLOOR

APPROX. GROSS INTERNAL AREA 788 sq.ft / 73.32 sq.m

COMPLIANT WITH RICS CODE OF MEASURING PRACTICE Floorplan is for illustrative purposes only and is not to scale. Every attempt has been made to ensure the accuracy of the floorplan shown, however all measurements, fixtures, fittings and data shown are an approximate interpretation for illustrative purposes only. Liability for errors, omissions or mis-statement through negligence or otherwise is hereby excluded.

